

(110° Sweep angle)

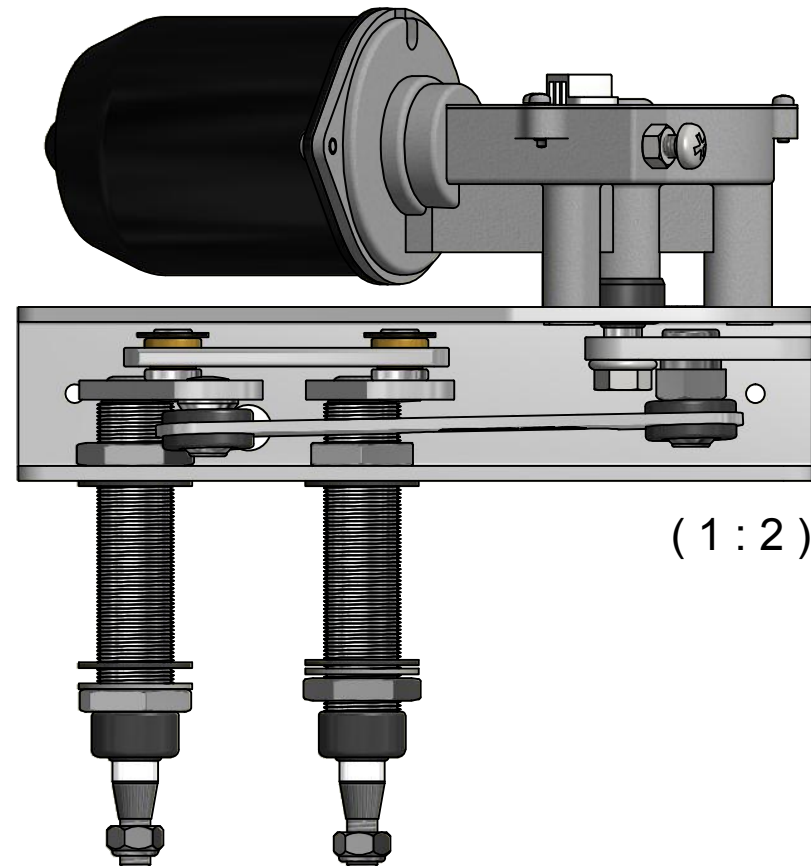

Specification		
	12V	24V
Speed no load - Slow/Fast	39 / 58 RPM	39 / 58 RPM
Current no load	< 3 A	< 2 A
Speed Rated Characteristics - Slow/Fast	34 / 54 RPM	34 / 54 RPM
Current Rated Characteristics - Slow/Fast	< 5 / < 7 A	< 3 / < 4 A
Stall Characteristics - Slow	38 Nm / < 36 A	38 Nm / < 18 A
Dynamic park circuit	Yes	Yes
Insulated ground	Yes	Yes
CISPER 25 class 1	Yes	Yes

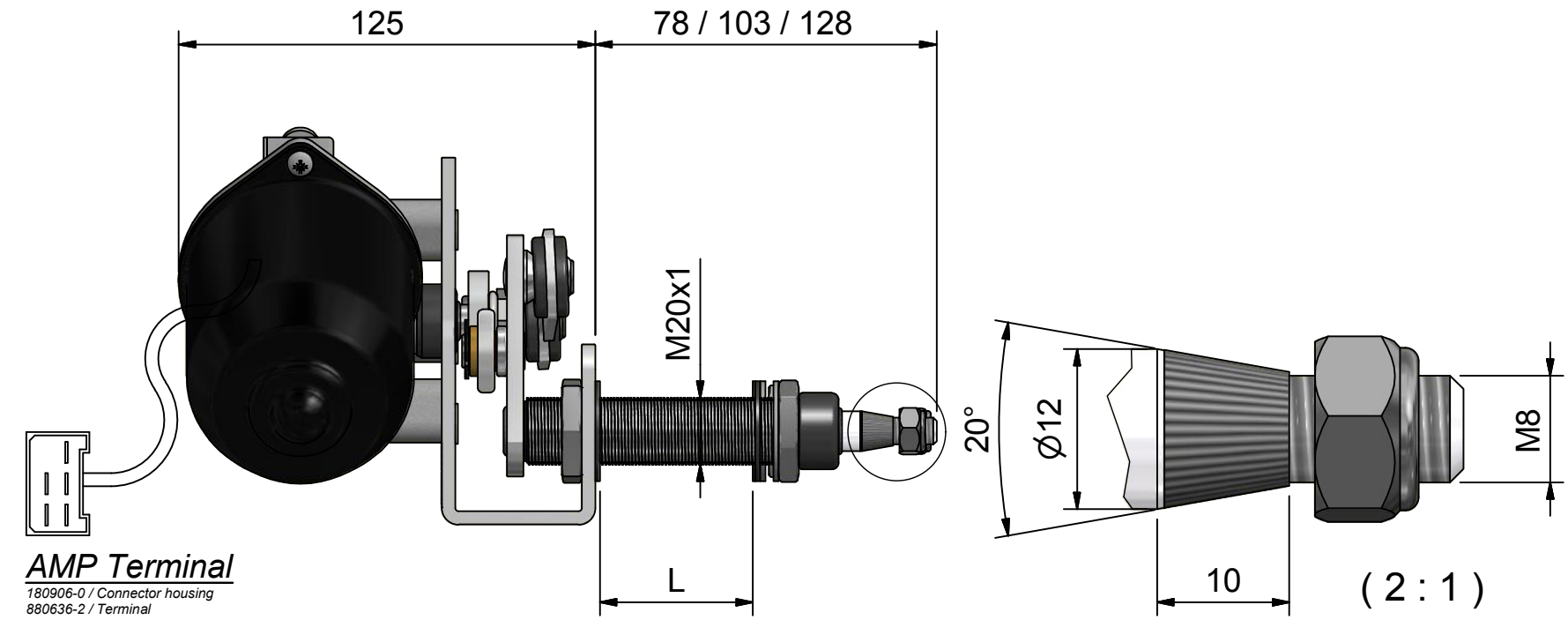
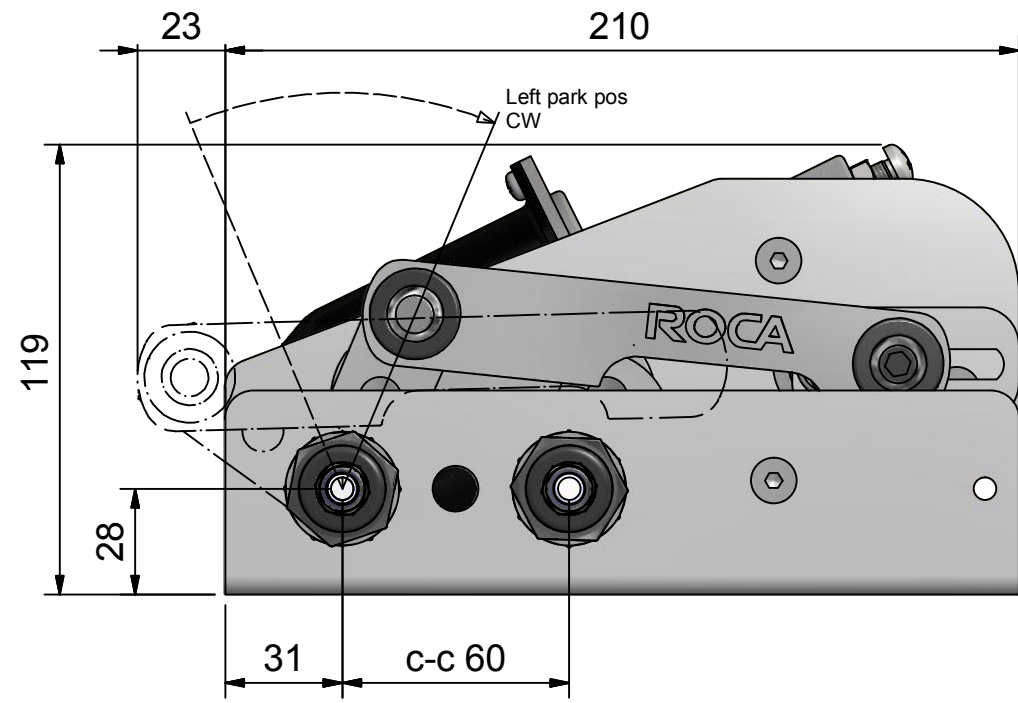
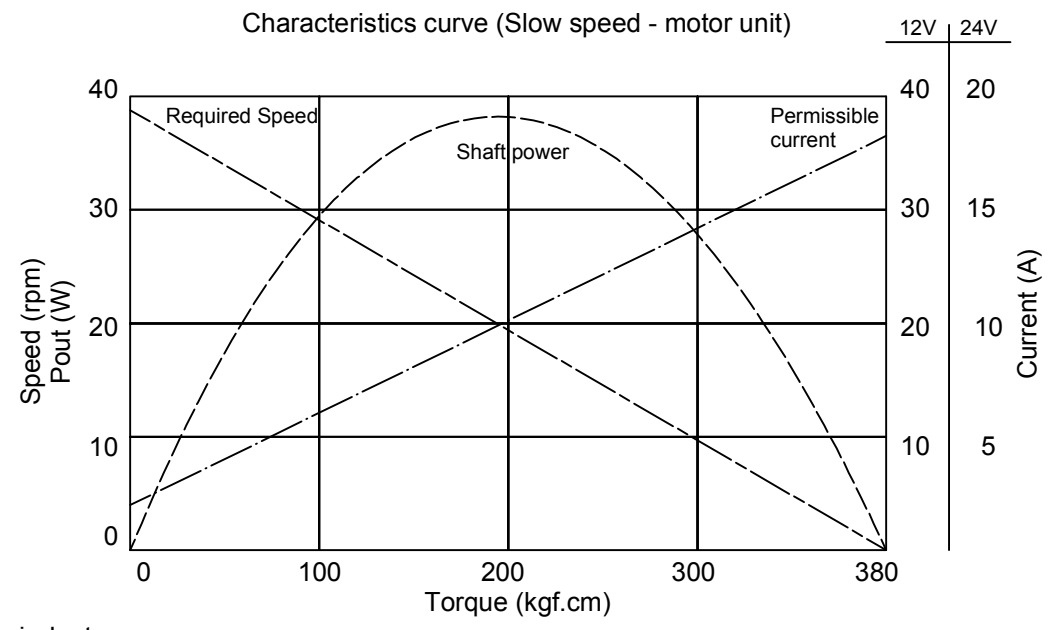

Item no.	L Max	Volt
531011	28	12
531012	28	24
531021	53	12
531022	53	24
531031	78	12
531032	78	24

W38 120119/LW
Wiper motor 531011-32



ROCA®

WIPER MOTOR | W38

Installation Instructions

Before installation please read these instructions.

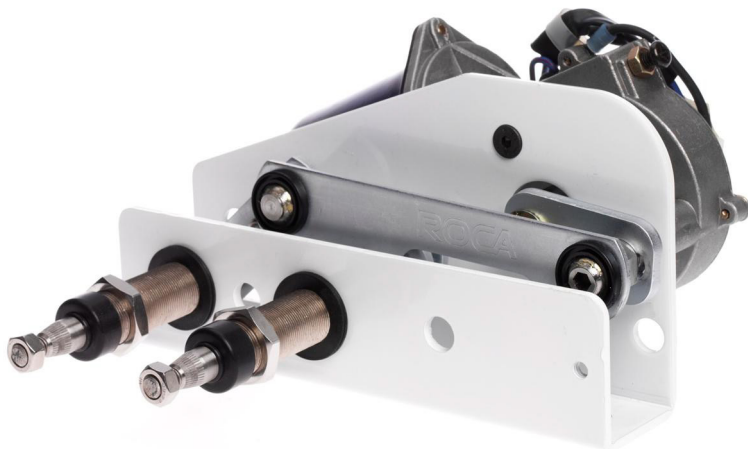

- 2 Speed, self-parking
- Heavy Duty motor, 38Nm
- Wipershaft in stainless steel
- Various sweep angle: 45 - 110°
- Dynamic park circuit
- Internal thermoswitch
- Insulated ground
- EMC protected
- Powers up to 900mm/900mm - Arm/blade combinations

Instructions - Adjusting the sweep angle and parking position

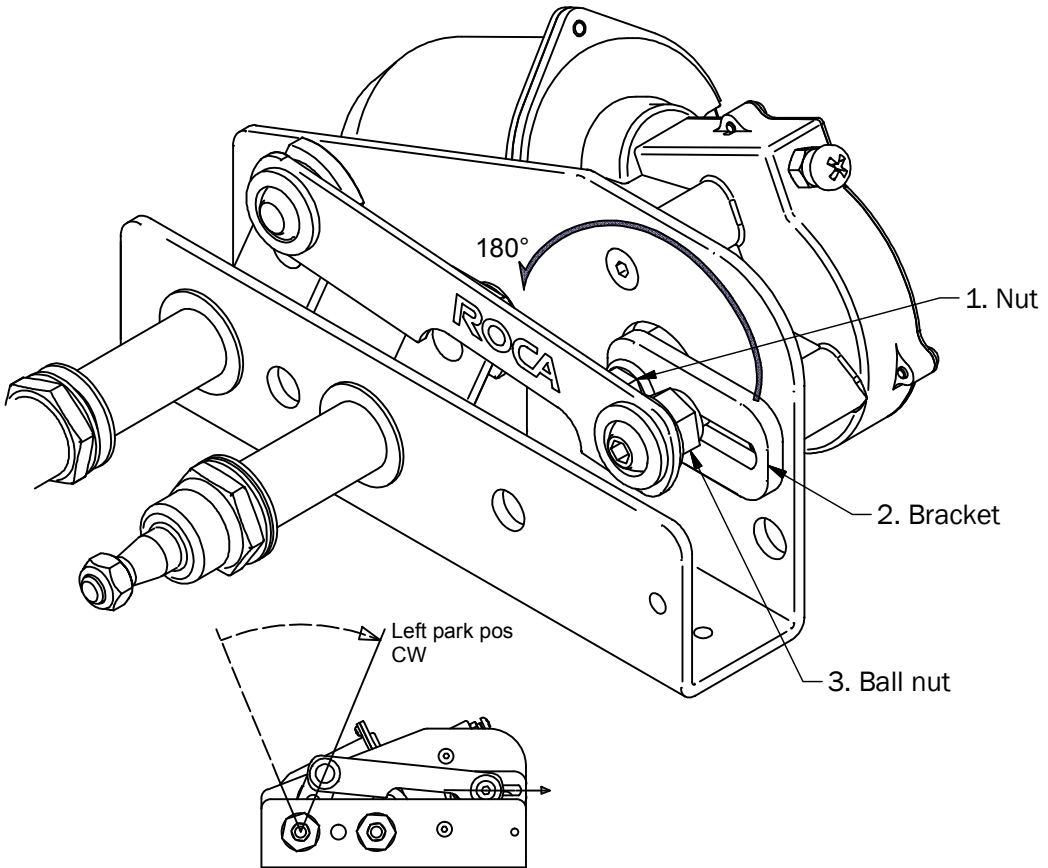

Changing the parking position.

Before the parking position is changed, the wiper motor should be in parked position (Default is set to left).

Keep battery main switch turned off during any operation inside of the wiper motor.

- **Loosen the nut (1).**
- **Remove the bracket (2) and rotate it 180°.**
- **Assemble the bracket and tighten the nut firmly.**

Change of wiped angle.

The wiped angle can be set at any point between 45° and 110°.
(Default is set to 45°).

Keep battery main switch turned off during any operation inside of the wiper motor.

- **Loosen the ball/nut (3).**
(Note: the ball/nut is left threaded to prevent it from coming loose when running).
- **Move the ball/nut to desired angle position and tighten it firmly.**

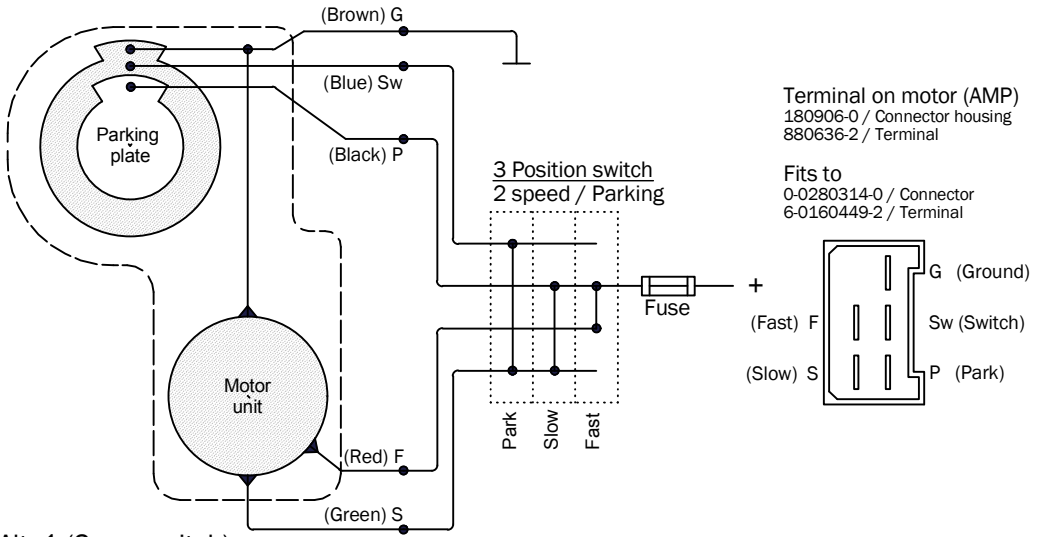

Alt. 1 (3 pos.switch)

Alt. 2 (Roca switch)

Actuator
466026

Switch
466221 / 12V
466222 / 24V

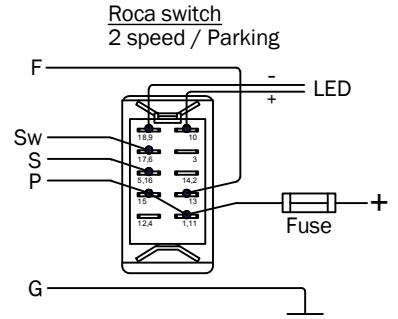
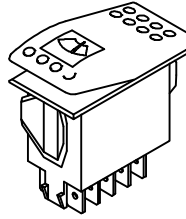

Alt. 3 (On/Off switch)

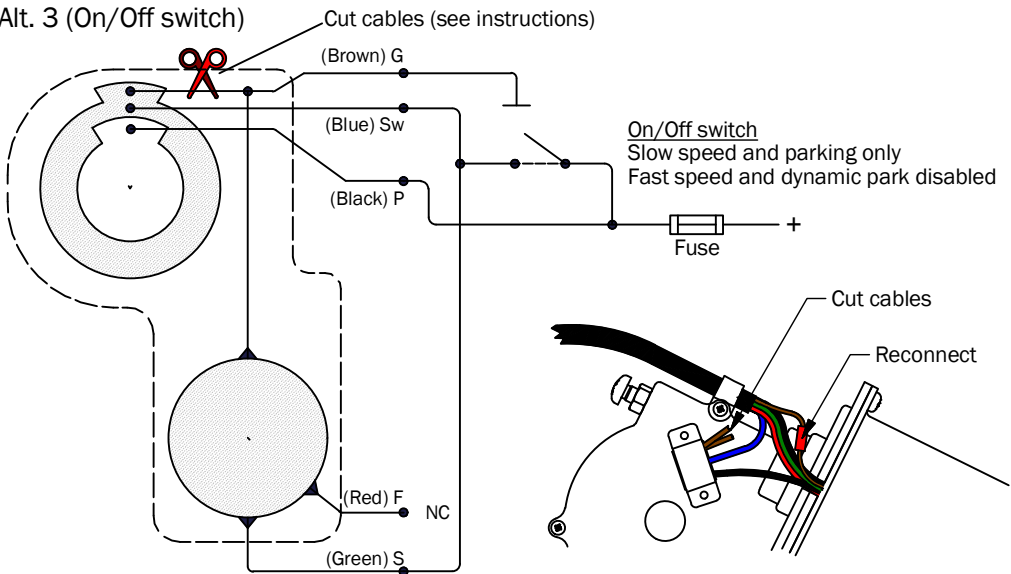

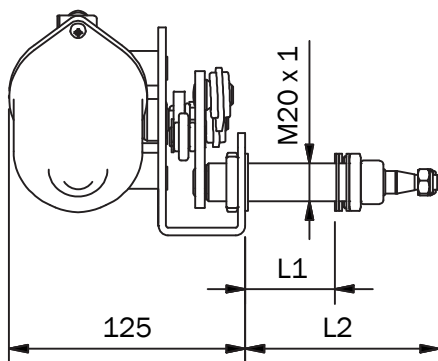
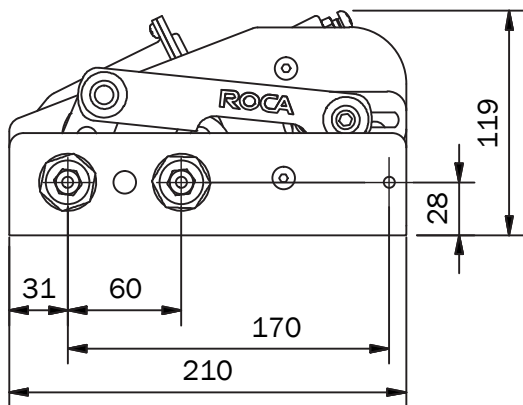

Variations:

Max length:		Voltage input:	
L1	L2	12 V	24 V
28	78	531011	531012
53	103	531021	531022
78	128	531031	531032

Current diagram:	12 V	24 V
No load	< 3 A	< 2 A
Normal running	< 7 A	< 4 A
Stall	< 36 A	< 18 A
Fuse	35 A	20 A

Limited warranty

- Roca warrants the wiper motors to be free from defective material and workmanship for a period of 3 years from the date of purchase.
- This warranty does not apply to failure or damage caused by improper installation, misuse, lightning strike or damage from a power surge.
- If failure occurs during this period, return it to your dealer for repair or replacement.

Wiper arms and blades:



Pantograph
536335 EP
538335 Black



Blade (22"-35")
520822 - 35