

↗ DOMETIC

COOLING BOXES

BORDBAR



TB08

EN	Thermoelectric cooler Operating manual	6
DE	Thermoelektrische Kühlbox Bedienungsanleitung	15
FR	Glacière thermoélectrique Notice d'utilisation	25
ES	Nevera termoeléctrica Instrucciones de uso	35
PT	Geleira termoeléctrica Manual de instruções	45
IT	Frigorifero termoelettrico Istruzioni per l'uso	55
NL	Thermo-elektrische koelbox Gebruiksaanwijzing	65
DA	Termoelektrisk køleboks Betjeningsvejledning	75

SV	Termoelektrisk kylbox Bruksanvisning	84
NO	Termoelektrisk kjøleboks Bruksanvisning	93
FI	Sähkökäyttöinen kylmälaukku Käyttöohje	102
RU	Термоэлектрический холодильник Инструкция по эксплуатации	111
PL	Przenośna lodówka termoelektryczna Instrukcja obsługi	121
SK	Termoelektrický chladiaci box Návod na obsluhu	131
CS	Termoelektrický chladič box Návod k obsluze	141
HU	Termoelektromos hűtőkészülék Használati utasítás	150

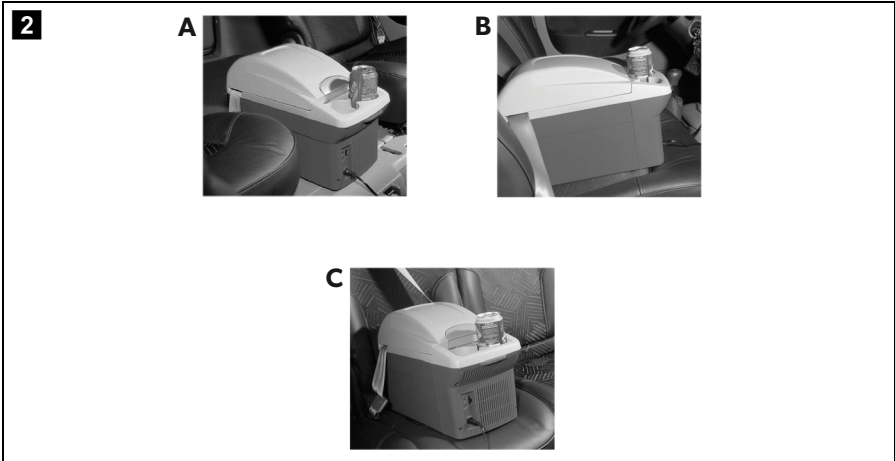
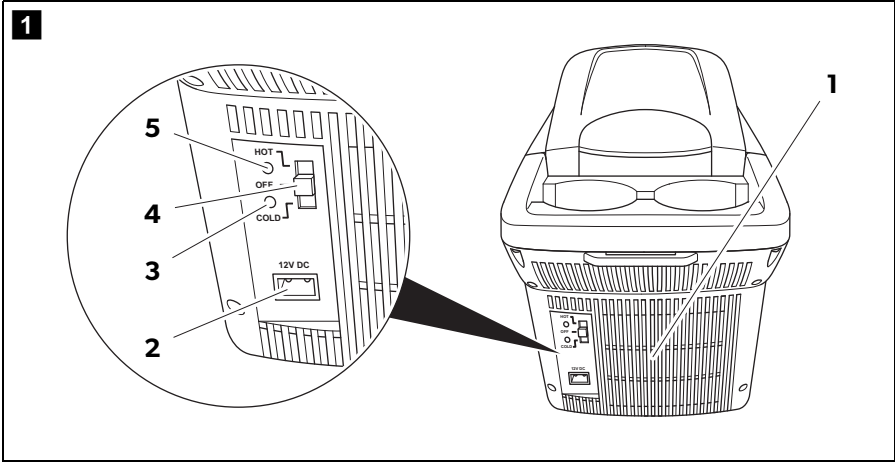

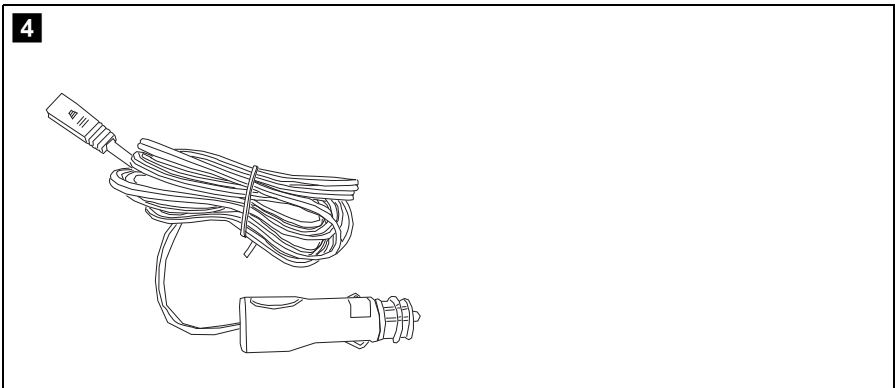
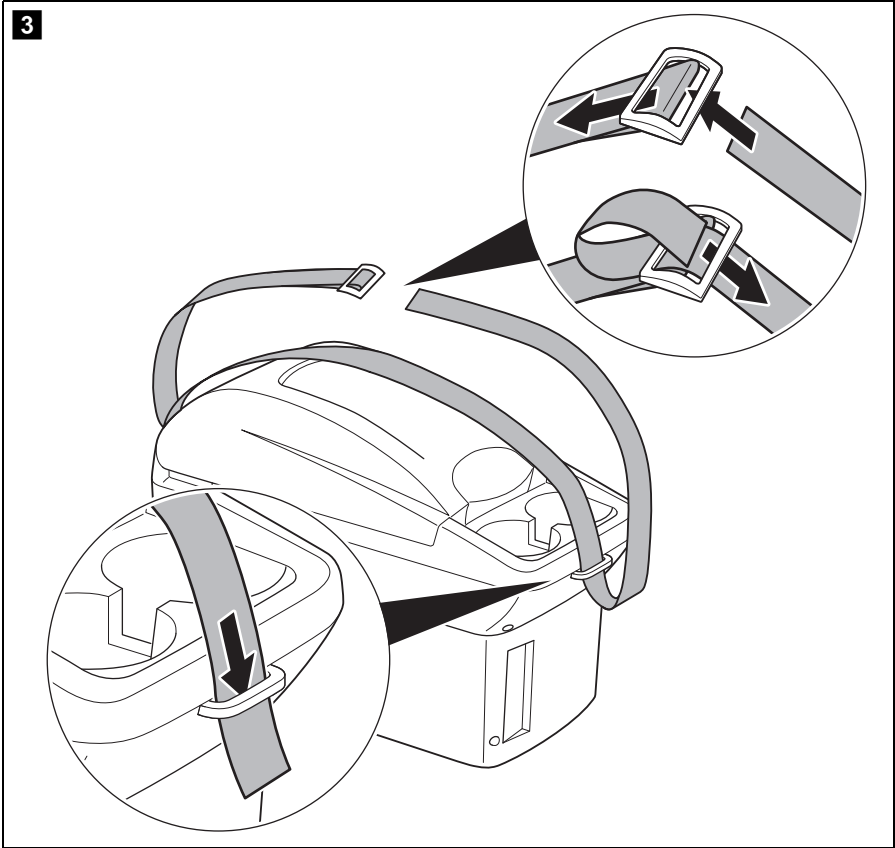

5

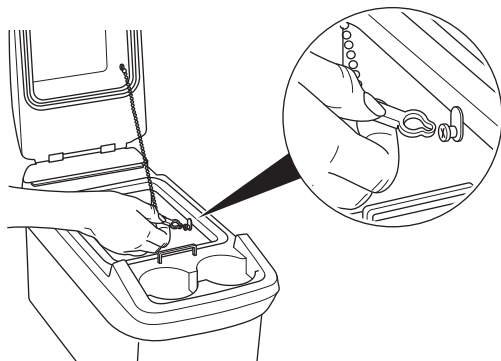

Please read this operating manual carefully before starting the device. Keep it in a safe place for future reference. If the device is passed on to another person, this operating manual must be handed over to the user along with it.

The manufacturer cannot be held liable for damage resulting from **improper usage** or **incorrect operation**.

Table of contents

1	Explanation of symbols	7
2	Safety instructions	7
3	Intended use	10
4	Scope of delivery	10
5	Technical description	10
6	Operation	11
7	Cleaning and maintenance	12
8	Warranty	12
9	Troubleshooting	13
10	Disposal	14
11	Technical data	14

1 Explanation of symbols

**DANGER!**

Safety instruction: Failure to observe this instruction will cause fatal or serious injury.

**WARNING!**

Safety instruction: Failure to observe this instruction can cause fatal or serious injury.

**CAUTION!**

Safety instruction: Failure to observe this instruction can lead to injury.

**NOTICE!**

Failure to observe this instruction can cause material damage and impair the function of the product.

**NOTE**

Supplementary information for operating the product.

2 Safety instructions

The manufacturer accepts no liability for damage in the following cases:

- Faulty assembly or connection
- Damage to the product resulting from mechanical influences and excess voltage
- Alterations to the product without express permission from the manufacturer
- Use for purposes other than those described in the operating manual

2.1 General safety

**DANGER!**

- On boats: If the appliance is powered by the mains, ensure that the power supply has a residual current circuit breaker.

**WARNING!**

- Do not operate the cooling appliance if it is visibly damaged.

- If the power cable for this cooler is damaged, it must be replaced by the manufacturer, customer service or a similarly qualified person in order to prevent safety hazards.
- This cooler only be repaired by qualified personnel. Inadequate repairs may cause serious hazards.
- This cooler can be used by children aged 8 years or over, as well as by persons with diminished physical, sensory or mental capacities or a lack of experience and knowledge, providing they are supervised or have been taught how to use the cooler safely and are aware of the resulting risks.
- Cleaning and user maintenance must not carried out by unsupervised children.
- Children should not play with the cooling appliance.
- Children must be supervised to ensure that they do not play with the cooling appliance.
- Always keep and use the cooler out of the reach of children under 8 years of age.
- Do not store any explosive substances, such as spray cans with propellants, in the cooler.

**CAUTION!**

- Disconnect the cooling appliance from the mains
 - Before cleaning and maintenance
 - After use
- Food may only be stored in its original packaging or in suitable containers.

**NOTICE!**

- Check that the voltage specification on the type plate is the same as that of the power supply.
- Only connect the cooler to the DC socket in the vehicle using the DC connection cable.
- Only connect the device as follows:
 - Plug the DC connection cable into the on-board socket in the vehicle
 - Or plug the AC connection cable into the AC mains
- Only use the AC connection cable to connect the device to the AC mains.
- Never pull the plug out of the socket by the connection cable.

- If the cooler is connected to the AC socket: disconnect the refrigerator and other electric consumers from the battery before connecting the quick charging device.
- If the cooler is connected to the DC socket: disconnect the refrigerator or switch it off when you turn off the engine. Otherwise you may discharge the battery.
- The cooling device is not suitable for transporting substances which are caustic or contain solvents.

2.2 Operating the cooler safely



DANGER!

- Do not touch exposed cables with your bare hands. This applies especially when operating the device from the AC mains.



CAUTION!

- Before starting the device, ensure that the power supply line and the plug are dry.



NOTICE!

- Do not use electrical devices inside the cooler unless they are recommended by the manufacturer for that purpose.
- Do not place the cooling appliance near naked flames or other heat sources (heaters, direct sunlight, gas ovens etc.).
- **Danger of overheating!**
Always ensure sufficient ventilation so that the heat generated during operation can dissipate. Make sure that the cooling appliance is sufficiently far away from walls and other objects so that the air can circulate.
- Ensure that the ventilation openings are not covered.
- Do not fill the inner container with ice or fluid.
- Never immerse the cooling appliance in water.
- Protect the cooling appliance and the cable against heat and moisture.

3 Intended use

The cooler is portable. It can chill products as well as keep them cool or warm.

The cooler has been designed for use with a DC socket of a car, boat or caravan.



CAUTION! Health hazard!

Please check if the cooling capacity of the device is suitable for storing the food or medicine you wish to cool.

4 Scope of delivery

- BordBar TB08 cooler
- Connection cable for DC connection
- Fastening and carrying strap

5 Technical description

The cooler can chill products to a maximum of 20 °C below the ambient temperature as well as cool or keep them warm up to a maximum of 65 °C.

Control elements

No. in fig. 1, page 3	Description
1	Ventilation grilles
2	DC socket connection
3	LED COLD lights up green when the device is cooling
4	Slide switch for the operating mode COLD: The device is cooling OFF: The device is switched off HOT: The device is warming
5	LED HOT lights up red when the device is warming

6 Operation



NOTICE!

- Ensure that only those objects are placed in the cooler that are intended to be cooled at the selected temperature.
- Ensure that food or liquids in glass containers are not excessively refrigerated. Liquids expand when they freeze and can therefore destroy glass containers.



NOTE

Before starting your new cooler for the first time, you should clean it inside and outside with a damp cloth for hygienic reasons (see also chapter "Cleaning and maintenance" on page 12).

Fastening the cooler on the seat

- Place the cooler on a seat (passenger seat or the middle seat in the back).
- Thread the seat belt into one of the belt holders and fasten the cooler onto the passenger seat (fig. **2** B, page 3) or the middle seat (fig. **2** C, page 3).
- If you want to position your cooler between two seats (fig. **2** A, page 3), use the fastening and carrying strap supplied (fig. **3**, page 4) to do this.

Switching the device on and off

- Plug the DC connection cable (fig. **4**, page 4) into the cigarette lighter socket in the vehicle.
- Push the slide switch into the required position.
- ✓ The cooler is switched on and starts cooling or heating the interior.
- ✓ The respective LED lights up.
- If you want to switch off the cooler, disconnect the plug.

Using the lock for the lid

You can keep the lid of the cooler open by hooking the chain in the screws on the inside (fig. **5**, page 5).

7 Cleaning and maintenance

**WARNING!**

Always disconnect the cooler from the mains before you clean and service it.

**NOTICE! Beware of damage**

- Never clean the cooler under running water or in dish water.
- Do not use abrasive cleaning agents or hard objects during cleaning as these can damage the cooling device.

- Occasionally clean the cooler interior and exterior with a damp cloth.
- Make sure that the air inlet and outlet vents on the cooler are free of any dust and dirt, so that heat can be released and the cooler is not damaged.
- Open the lid if the cooler is not going to be used for a long time.

8 Warranty

The statutory warranty period applies. If the product is defective, please contact the manufacturer's branch in your country (see the back of the instruction manual for the addresses) or your retailer.

For repair and guarantee processing, please include the following documents when you send in the device:

- A copy of the receipt with purchasing date
- A reason for the claim or description of the fault

9 Troubleshooting

Problem	Possible cause	Suggested remedy
Your cooler is not working and the fan wheel which can be seen from the outside is not turning.	No voltage is flowing from the cigarette lighter in your vehicle.	The ignition must be switched on in most vehicles to supply current to the cigarette lighter.
The ignition is on and the cooler is not working. Pull the plug out of the socket immediately and make the following inspections.	The cigarette lighter socket is dirty. This results in a poor electrical contact.	Clean the socket of the cigarette lighter with a non-metallic brush and a solvent, to ensure that the middle contact pin is clean. If the plug of your cooler becomes very warm in the cigarette lighter socket, either the socket must be cleaned or the plug has not been assembled correctly.
	The fuse of the connection cable has blown.	Replace the connection cable fuse (5 A).
	The vehicle fuse has blown.	Replace the vehicle cigarette lighter fuse (usually 15 A). Please refer to the operating manual of your vehicle.
Your cooler does not cool satisfactorily and the outer fan wheel is not turning.	The fan motor is defective.	This can only be repaired by an authorised repair centre.
The cooler does not cool satisfactorily and the outer fan wheel is turning.	The fan motor for the inner fan is defective.	This can only be repaired by an authorised repair centre.
	The Peltier element is defective.	
	The integrated mains adapter is defective.	This can only be repaired by an authorised repair centre.

10 Disposal

- Place the packaging material in the appropriate recycling waste bins wherever possible.



If you wish to finally dispose of the product, ask your local recycling centre or specialist dealer for details about how to do this in accordance with the applicable disposal regulations.

11 Technical data

BordBar TB08	
Ref. no.:	9600000488
Voltage:	12 V ⁼⁼⁼
Power consumption:	32 W
Cooling capacity:	max. 20 °C below ambient temperature
Heating capacity:	65 °C (interior temperature)
Capacity:	approx. 8 l
Climatic class:	N, T
Weight:	3.1 kg
Inspection/certification:	